



MONTINI

SPECIAL ELECTRIC FORKLIFT TRUCKS



THE NEW **COMPACT** FORKLIFT TRUCKS

MR
1.7
COMPACT

MR
2.0
COMPACT

MR
2.5
COMPACT

After the “Revolution” in its range of heavy-duty forklifts, MONTINI presents the new electric 4-wheel forklift trucks of the “MR COMPACT” series: a new “Revolution” in the field of compact forklifts.

UNRIVALLED COMPACTNESS

WHY SO COMPACT?

Because these forklifts are standard equipped with **MONTINI SUPER STEERING**, i.e. rear axle steering up to 101 degrees so it can steer in the same space as a 3-wheel forklift.

MR COMPACT forklifts are ideal vehicles for meeting the compactness required by users who need an **unbeatable turning radius for maximum efficiency when operating in fruit and vegetables warehouses, narrow storage aisles, cold stores and confined spaces.**



MR
1.7
COMPACT

(48V - 1750 kg nominal capacity at load centre 500 mm)

Length (l2): 1945 mm
Width (b1): 1030 mm
Turning radius (Wa): 1558 mm

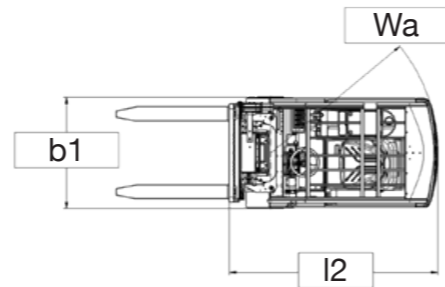

MR
2.0
COMPACT

(48V - 2000 kg nominal capacity at load centre 500 mm)

Length (l2): 1945 mm
Width (b1): 1050 mm
Turning radius (Wa): 1558 mm

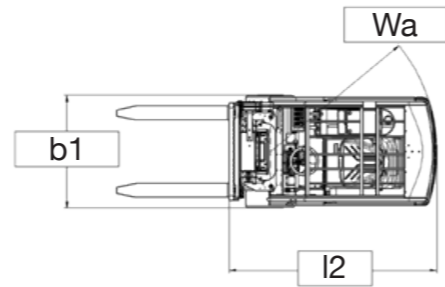

MR
2.5
COMPACT

(80V - 2500 kg nominal capacity at load centre 500 mm)

Length (l2): 2120 mm
Width (b1): 1180 mm
Turning radius (Wa): 1685 mm

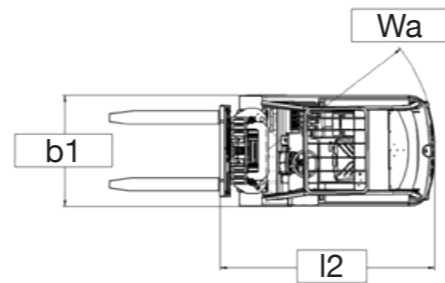

EQUIPPED WITH BATTERIES WITH A HIGH AMP/H CAPACITY

FOR PROLONGED OPERATING AUTONOMY

The forklifts in the “MR COMPACT” range can be equipped with **high Amp/h capacity batteries**, up to 1120Ah (for 48V forklifts) and 860Ah (for 80V forklifts), so as to:

- meet **any kind of work requirement** (wide range of batteries for demanding applications; low water consumption; for very heavy and intensive applications, in particular for forklifts fitted with auxiliary equipment);
- guarantee **unbeatable work autonomy** (up to 14 hours/day);
- **work better, work more**, while safeguarding health and the environment.



MR
1.7
COMPACT

48V - maximum battery 1120Ah

MR
2.0
COMPACT

48V - maximum battery 1120Ah

MR
2.5
COMPACT

80V - maximum battery 860Ah

Battery box and cover are designed so as to convey any fumes out of the driver's cab.



New catch for easy opening of the battery cover.



RECORD LOAD CAPACITIES

AT MAXIMUM LIFT HEIGHT, IN TOTAL SAFETY

The **lifting units**, designed and manufactured by MONTINI, are **available in Duplex (DX) and Triplex (TX) versions, with total visibility (T.V.) and total free lift (T.F.L.)**, so as to:

- have maximum smoothness and greater stability;
- meet the most varied working requirements;
- ensure total safety during high lifts and optimum load capacity.

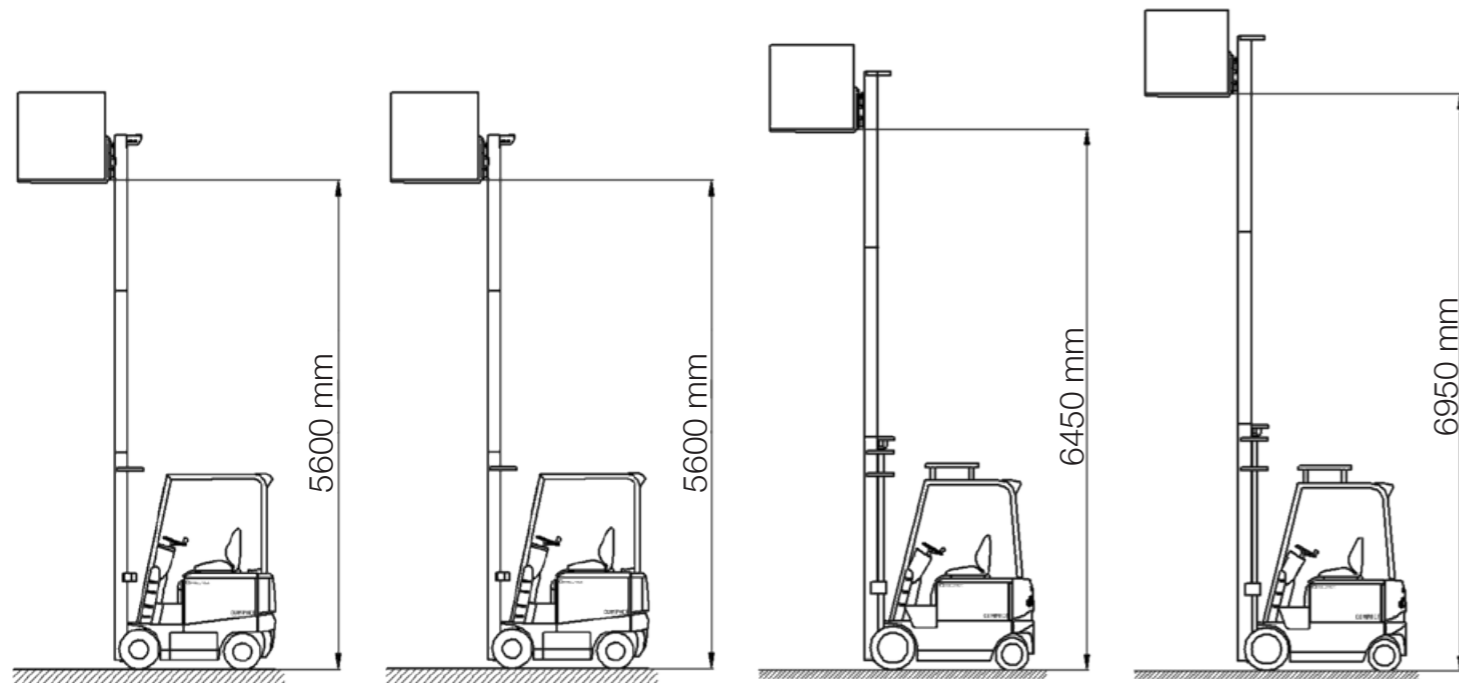

MR
1.7
COMPACT

1350 kg
lift height 5600 mm
load centre 500 mm

MR
2.0
COMPACT

1500 kg
lift height 5600 mm
load centre 500 mm

MR
2.5
COMPACT.P

1650 kg
lift height 6450 mm
load centre 500 mm

MR
2.5
COMPACT.P

1600 kg
lift height 6950 mm
load centre 500 mm

SAFETY, COMFORT, MANOEUVRABILITY, AUTONOMY

THE BEST WAY TO WORK



THE BETTER YOU WORK, THE MORE YOU WORK

Standard equipped with hydraulic control valve with 3 handy levers, made of pleasant to handle soft material, for lifting, sideshifting and tilting operations.

Possibility to equip the forklift truck with optional 4th and 5th levers to the control valve, with hydraulic piping up to the fork carriage.

The 4th and 5th functions are required when installing an auxiliary equipment on the forklift truck.



PRECISION AND PERFORMANCE, THANKS TO THE HYDRAULIC CONTROLS

These forklift trucks can be equipped at choice with **different hydraulic controls** to ensure maximum efficiency and productivity, not to mention exceptional driving comfort.

The intuitive and ergonomic hydraulic control with **joystick** allows the operator to activate all the hydraulic functions of the lift truck using a single control lever. Maximum productivity thanks to the use of two simultaneous operating functions of the lifting unit.



The simple to use and easily accessible hydraulic control with **fingertips** (mini-levers) is installed in an ergonomic and adjustable armrest. Simply operate the fingertip controls gently for agile, precise and safe handling.



The hydraulic control with **pilot levers** (mini-joysticks) makes driving the forklift truck easy and reliable. Easily accessible and simple to use, it is installed in an ergonomic and adjustable armrest to guarantee comfortable driving positions.









ELECTRONIC TECHNOLOGY

The **innovative electronic technology**, developed in German research laboratories, **with alternating current inverters and Can Bus communication**, guarantees high efficiency and low energy consumption; it comes with a new diagnosis system for keeping everything under control and reducing any machine downtime.

The large colour display, with multifunction buttons, **ensure accessibility and control of the forklift's basic functions**.

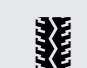

The functions are defined by icons displayed on the relative bar, for example:

-  handbrake locked;
-  seat belt not fastened;
-  seat switch open;
-  rear wheel not straight;
-  brake fluid level too low;
-  maintenance hour meter expired;
-  activates "tortoise speed";
-  deactivates "tortoise speed".

Access password personalised for the operator.



SERVICES AND SAFETY

Possibility to equip the forklifts with **GPRS system** (General Packet Radio System), mobile phone technology, installed on the battery of the forklift, **to check:**

- **correct battery use and management** (to check regular charge and discharge of the battery, correct operation of the battery charger during charging and the electrolyte level inside the battery cells);
- **the registration of possible forklift collisions.**

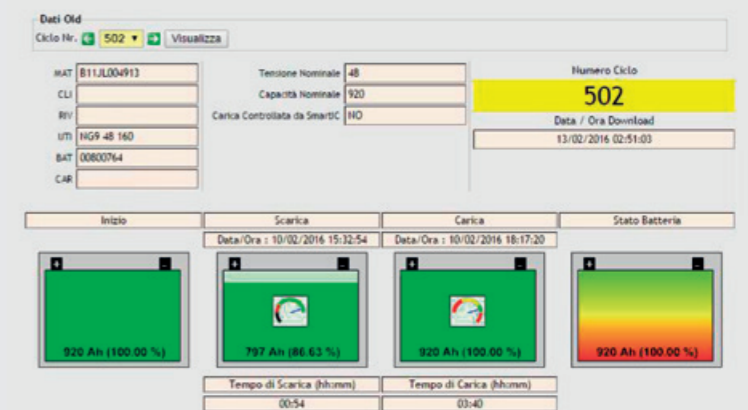

Possibility to equip forklifts with the **innovative "Remote Control" system** for rapidly detecting any electric faults through remote data transmission, to localize the forklift, activate the anti-theft device and block the forklift functions.

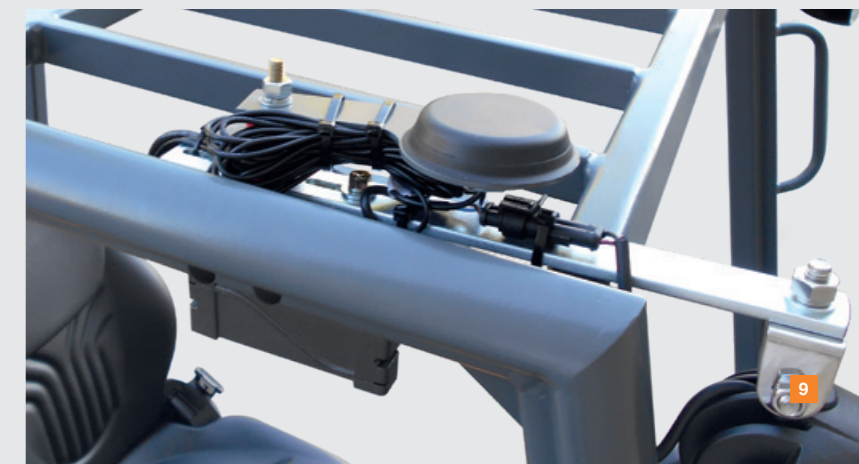

EQUIPMENT VARIATIONS

OVERHEAD GUARD

Overhead guard designed to be equipped easily with cab at any time, without having to modify or replace the original structure.

It can be cabled:

- with full panelling, complete with windows and windscreen wipers, also on the overhead guard;
- with or without heating system.



SOUNDPROOFED OVERHEAD GUARD

The overhead guard on the MR 2.5 COMPACT XL forklift, is joined to the forklift chassis using **6 special vibration dampers (silent block)** which reduce vibrations and noises inside the cab for increased operator comfort.



HEATED WINDOWS

As an optional, cabs can be with **innovative heated (or thermal) windows**.

The heated window is made from “coated” glass, with anti-fogging as its main feature.

Coated glass is made by depositing metal oxides with good electric conductivity and optical transparency on the surface.

Electricity is passed through the coating and guarantees total resistance to fogging while at the same time creating the ideal temperature inside the cab for the operator.

SPECIAL OVERHEAD GUARD

Special overhead guard for **drive-in** version, with adequately protected LED lights.

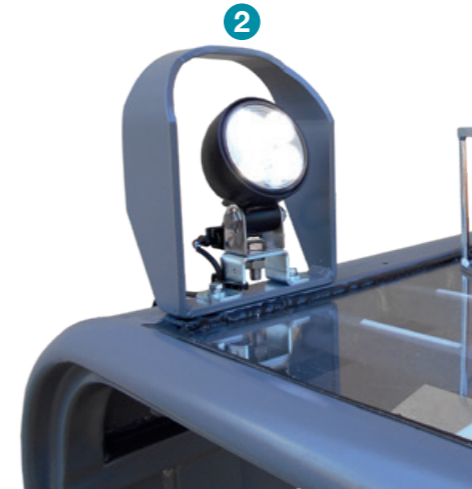

SAFETY GRID

Upper protection iron grid on the overhead guard when fitted with glass and wiper, for protection against accidental load fall.



HEATER

The **heater**, available as an optional extra, directly and quickly heats up the cab interior thanks to the hot air vents, thus making sure that the temperature inside the cab is always comfortable.



HYDRAULIC FORK POSITIONER

The MONTINI lifting unit has been designed to offer the best visibility in all working conditions.

A newly designed sideshift has been incorporated into the lifting unit which is very compact and provides excellent visibility.

The optional MONTINI hydraulic fork positioner allows precise movement and positioning of the forks.



LIGHTING EQUIPMENT

Adjustable LED working lights.

Blue LED device to signal the forklift's presence (blue spotlight).



SEATS

“Grammer Primo M” standard seat.

Standard equipped with “Primo M” PVC seat which reduces vibrations transmitted to the operator.

- 1 Lumbar support
- 2 Seat belt
- 3 Backrest adjustment
- 4 Weight adjustment
- 5 Longitudinal adjustment



“Grammer Primo M” seat kit complete with armrests and headrest, in fabric (optional).

Optional possibility to set **different parameter configurations for the safety belt** in order to prevent or rather to eliminate dangers and damages deriving from incorrect use of safety belt by the forklift driver while working.



New design concept applied to the seat. “Grammer Primo L” seat (optional).

Seat kit with armrests and headrest, in PVC or fabric, also with heating.

- 1 Headrest
- 2 Heating system
- 3 Tilting left armrest
- 4 Tilting right armrest
- 5 Fabric cover
- 6 Pneumatic suspension



Characteristics	MONTINI		MONTINI		
	MR 1.7 COMPACT	MR 2.0 COMPACT	MR 1.7 COMPACT	MR 2.0 COMPACT	
1.1	Manufacturer		MONTINI	MONTINI	
1.2	Model		MR 1.7 COMPACT	MR 2.0 COMPACT	
1.3	Drive: electric, diesel, petrol, L.P. gas, electric mains		electric	electric	
1.4	Operation: manual, pedestrian, stand-on, seated, order picker		seated	seated	
1.5	Capacity/Load	Q (t)	1,75	2	
1.6	Load centre	c (mm)	500	500	
1.8	Load distance	x (mm)	391	391	
1.9	Wheelbase	y (mm)	1180	1180	
Weights	2.1	Weight	Kg	3430	3700
	2.2	Axle loading, laden, front/rear	Kg	4517/663	4935/765
	2.3	Axle loading, unladen, front/rear	Kg	1450/1980	1430/2270
Equipment	3.1	Tyres: superelastic (SE), cushion (C), pneumatic (PN)		SE/C/PN	SE/C/PN
	3.2	Tyre size, front		18x7-8 1.	200/50-10 2.
	3.3	Tyre size, rear		16x6-8 4.	16x6-8 5.
	3.5	Wheels, number front/rear (x=driven wheel)		2x/2	2x/2
Basic dimensions	3.6	Tread width, front	b10 (mm)	874 6.	854 7.
	3.7	Tread width, rear	b11 (mm)	838,5 9.	838,5 9.
	4.1	Max. tilt of mast/fork carriage, forward/backward (α-β)	Degrees	3°/8°	3°/8°
	4.2	Lowered mast height	h1 (mm)	2165	2165
	4.3	Free lift	h2 (mm)	-	-
	4.4	Lift height	h3 (mm)	3300	3300
	4.5	Extended mast height	h4 (mm)	3850	3850
	4.7	Overhead guard height	h6 (mm)	2239	2239
	4.8	Seat height	h7 (mm)	1160	1160
	4.12	Tow coupling height	h10 (mm)	555	555
	4.19	Total length	l1 (mm)	2945	2945
	4.20	Length to face of forks	l2 (mm)	1945	1945
	4.21	Overall width	b1/b2 (mm)	1030/1010 11.	1050/1010 12.
	4.22	Forks dimensions	s/e/l (mm)	35/100/1000	35/120/1000
	4.23	Fork carriage ISO 2330, class/type A, B		ISO 2A	ISO 2A
	4.24	Min. fork carriage width	b3 (mm)	910	910
	4.31	Ground clearance, under mast, laden	m1 (mm)	85	85
	4.32	Ground clearance, centre of wheelbase, laden	m2 (mm)	100	100
	4.33	Aisle width with pallet 1000x1200 (l6xb12), pick-up side 1200	Ast (mm)	3149 15.	3149 15.
	4.34	Aisle width with pallet 800x1200 (b12xl6), pick-up side 800	Ast (mm)	3349 15.	3349 15.
4.35	Turning radius	Wa (mm)	1558	1558	
4.36	Distance from turning centre and truck centre axis	b13 (mm)	0	0	
Performance data	5.1	Travel speed, laden/unladen	Km/h	15	15
	5.2	Lift speed, laden/unladen	m/s	0,30/0,45	0,30/0,45
	5.3	Lowering speed, laden/unladen	m/s	0,52/0,50	0,52/0,50
	5.5	Drawbar pull, laden/unladen	daN	3790/4090	3790/4090
	5.6	Max. drawbar pull, laden/unladen	daN	10000/10230	10000/10230
	5.7	Gradeability, laden/unladen	%	9,2/17,2	9,2/17,2
	5.8	Max. gradeability, laden/unladen	%	24,5/36,8	24,5/36,8
	5.9	Acceleration time, laden/unladen	s	5,8/4,9	5,8/4,9
	5.10	Service brake		hydraulic/electric	hydraulic/electric
	Electric motor	6.1	Drive motor, output S2 60 min.	Kw	2x3,8
6.2		Lift motor, output at S3 15%	Kw	11	11
6.3		Battery according to DIN 43531/35/36 A, B, C		not provided	not provided
6.4		Rated voltage/capacity 5h	V/Ah	48/630-1120	48/630-1120
6.5		Battery weight, min./max.	Kg	1360/1460	1360/1460
6.6		Energy consumption according to VDI cycle	KWh/h	-	-
Misc.	8.1	Type of electronic control		inverter	inverter
	8.2	Working pressure for auxiliary equipment	bar	150	150
	8.3	Oil volume for auxiliary equipment	l/min	-	-
	8.4	Sound pressure level at operator's ear	db (A)	< 80 db (A)	< 80 db (A)
	8.5	Tow coupling, model/type		-	-

MONTINI		MONTINI		MONTINI		MONTINI	
MR 2.5 COMPACT		MR 2.5 COMPACT.P		MR 2.5 COMPACT XL		MR 2.5 COMPACT.P XL	
	electric		electric		electric		electric
	seated		seated		seated		seated
	2,5		2,5		2,5		2,5
	500		500		500		500
	435		455		435		455
	1420		1420		1420		1420
	4600		5100		4600		5100
	6345/755		6830/770		6345/755		6830/770
	2200/2400		2650/2450		2200/2400		2650/2450
	SE/C		C		SE/C		C
	21x8-9 3.		533x203-381		21x8-9 3.		533x203-381
	16x6-8 5.		394x152-254		16x6-8 5.		394x152-254
	2x/2		2x/2		2x/2		2x/2
	948 8.		910		948 8.		910
	854 10.		854		854 10.		854
	3,5°/6°		3°/6,5°		3,5°/6°		3°/6°
	2307		2630		2307		2630
	-		-		-		-
	3405		6000		3405		6000
	4012		6597		4012		6597
	2265		2265		2424		2424
	1170		1170		1329		1329
	600		600		600		600
	3120		3140		3120		3140
	2120		2140		2120		2140
	1180/1100 13.		1110/1100		1180/1100 13.		1110/1100
	40/130/1000		40/130/1000		40/130/1000		40/130/1000
	ISO 2A		ISO 2A		ISO 2A		ISO 2A
	910 14.		910 14.		910 14.		910 14.
	95		95		95		95
	110		110		110		110
	3320 15.		3340 15.		3320 15.		3340 15.
	3520 15.		3540 15.		3520 15.		3540 15.
	1685		1685		1685		1685
	0		0		0		0
	16		15		16		15
	0,40/0,46		0,38/0,45		0,40/0,46		0,38/0,45
	0,58/0,56		0,57/0,38		0,58/0,56		0,57/0,38
	7210/7570		7210/7570		7210/7570		7210/7570
	10750/11620		10750/11620		10750/11620		10750/11620
	10/16		10/16		10/16		10/16
	14/23,5		14/23,5		14/23,5		14/23,5
	5,2/5		5,2/5		5,2/5		5,2/5
	hydraulic/electric		hydraulic/electric		hydraulic/electric		hydraulic/electric
	2x8		2x8		2x8		2x8
	16,2		16,2		16,2		16,2
	not provided		not provided		not provided		not provided
	80/625-690		80/625-690		80/700-860		80/700-860
	1330/1530		1330/1530		1915/2106		1915/2106
	-		-		-		-
	inverter		inverter		inverter		inverter
	150		150		150		150
	-		-		-		-
	< 75 db (A)		< 75 db (A)		< 75 db (A)		< 75 db (A)
	-		-		-		-

MR 1.7 COMPACT MR 2.0 COMPACT

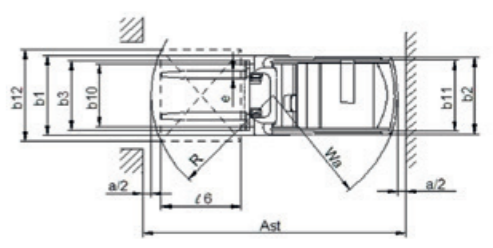
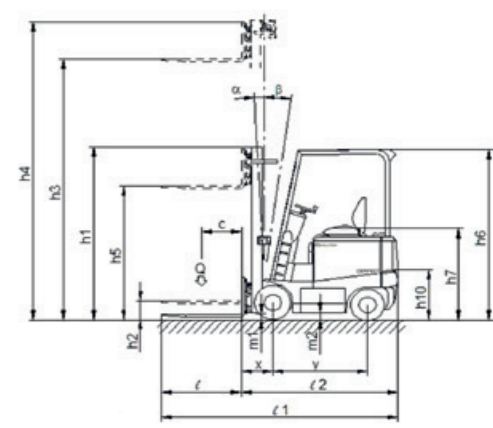

MR 2.5 COMPACT

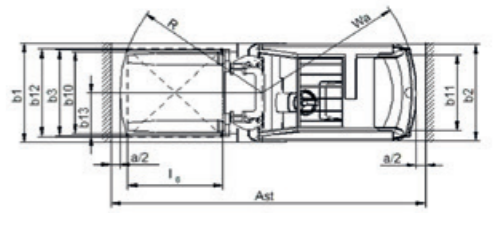
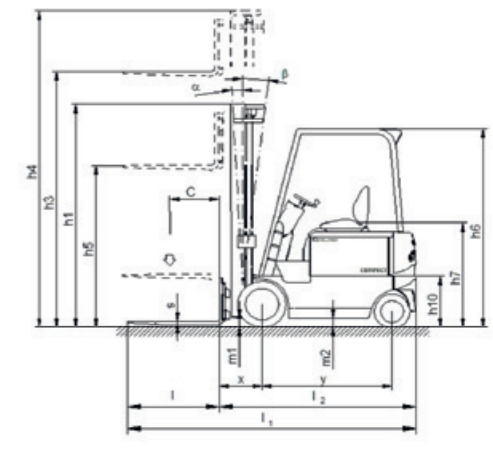

All MONTINI products comply with Machinery Directive 2006/42/EC, Directives 2014/35/EU and 2014/30/EU.

1. Optional cushion tyres 457x152-308
2. Optional cushion tyres 457x178-308
3. Optional cushion tyres 533x203-381
4. Optional cushion tyres 394x127-254
5. Optional cushion tyres 394x152-254
6. With cushion tyres 878
7. With cushion tyres 872
8. With cushion tyres 910
9. With cushion tyres 842,5

10. With cushion tyres 858
11. With cushion tyres 1030/1010
12. With cushion tyres 1050/1010
13. With cushion tyres 1110/1100
14. With load backrest 940
15. Ast = Wa + x + l6 + a (a = 200 mm)



MONTINI

SPECIAL ELECTRIC FORKLIFT TRUCKS

Choose specialization.

Choose MONTINI special electric lift trucks.

MONTINI di Garotti Francesco & C. s.n.c.

IT - 48022 Lugo RA
Via A. da Barbiano, 8-10
Tel. +39 0545 991001
Fax +39 0545 42150



info@montini.biz
www.montini.biz